

maineframe

maine

Ambidextrous



Contemporary



Maineframe is an innovative new product designed by Maine. The storage units are based on the classic Maineseries31 range and have all the benefits of this flexible and durable design range as well as offering tambour fronts. Maineframe is available in 7 different heights and 2 different widths, allowing complete flexibility to suit your requirements. With the added benefit of optional desks as part of the Maineframe range, we provide the complete workplace solution.

No matter how hard you try, there is often dead space under a desk that is difficult to utilise. Maineframe's new innovation offers a solution, making use of this space by providing efficient and productive storage in its place. The centre storage unit is custom built to requirement and can support alternate desks on either side. Each desk has access to many different types of storage that can be custom specified in your own unique design.

Maine units can be manufactured in any colour, including tonal shades and corporate colours. These colours can be specified from BS, RAL, Pantone or Dulux Colour Dimensions palettes as well as specialist paints, including Hammerite, Metallic, Polychromatic, and Pearlescent finishes.



maineframe

Sizes

- Depth** 457mm (all units)
- Widths** 800mm and 1000mm
- Heights** Drawers 403mm, 682mm, 713mm, 992mm, 1085mm, 1147mm and 1302mm.
Cupboards 403mm, 682mm, 713mm, 992mm, 1085mm, 1147mm and 1302mm.
Other sizes available upon request

Capacities

Drawer units

Files A4 or foolscap suspension and binders spine-up

Capacity Height 310mm

Unit width	Capacity
800mm	718mm
1000mm	918mm



Cupboard units

Files A4 lever arch files

Capacity depth 410mm

Unit width	Capacity	A4 lever arch per shelf
800mm	760mm	10
1000mm	960mm	12

Maineframe vertical capacities - for A4 lever arch files

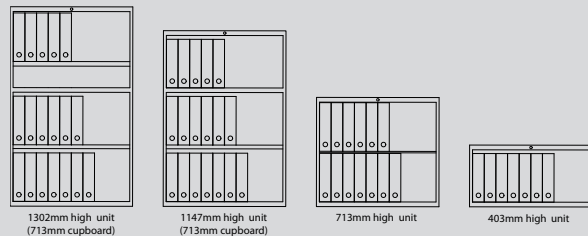

Media size 290mm (width) x 317mm (height) x 75mm (depth)

Multi - units

Files A4 or foolscap suspension and A4 lever arch files

Accessories

Ask for our accessories information for further internal options.

All our standard units are complete with the following:
Shelves, label holders, file bars, levelling glides.
Cupboards all have independently opening doors.
Locks are fitted on all units.

Counterbalance weight

(CBW) recommended for free standing units under 1023mm high

Material Steel & laminated doors

Finishes Powder coated

Colours RAL, Dulux, Pantone

front

back

size

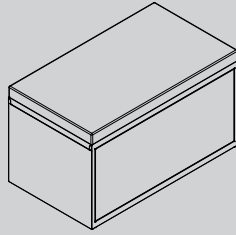
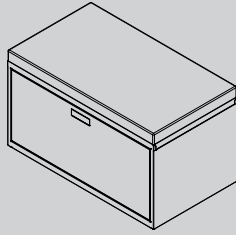

403mm high Drawer Unit
With a seat cushion

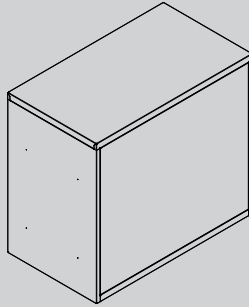
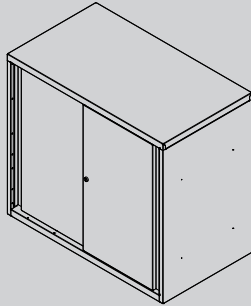

713mm high
Sliding Doors
Solid rear panel

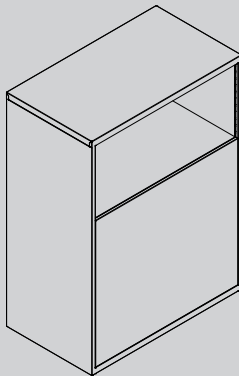
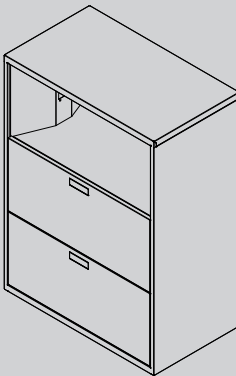

1147mm high
Open section with drawers
Solid rear panel to drawers

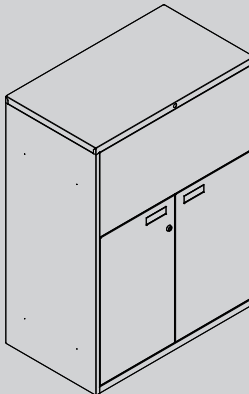
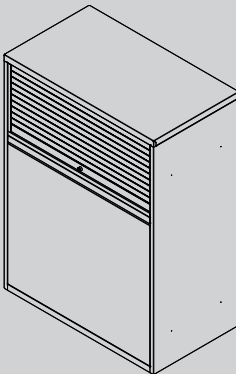

1302mm high
Vertical tambour with cupboard

options

Pedestal with Cupboard

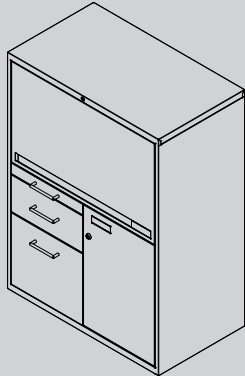

Open Section with Cupboard below

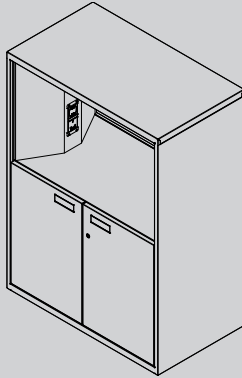

Locker unit

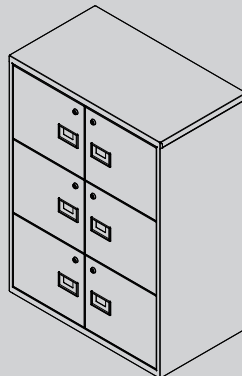

Tambour roller shutter two filedrawers below 2 file drawers below

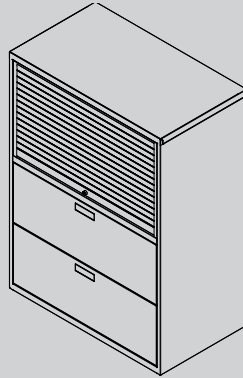

Recycle Unit

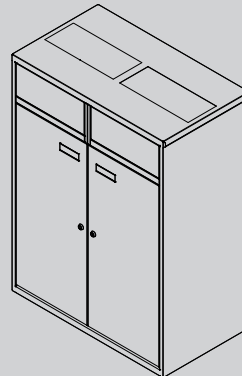

Sliding door top section with sliding doors below

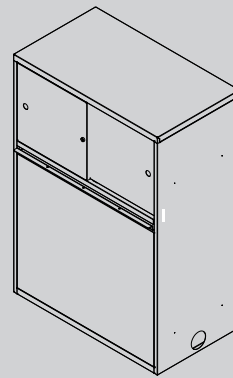

Whiteboard

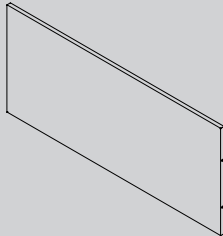

Pinboard

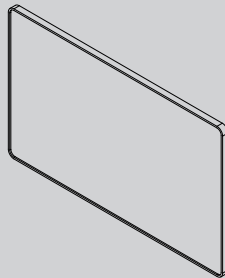

Perforated Panel with acoustic foam

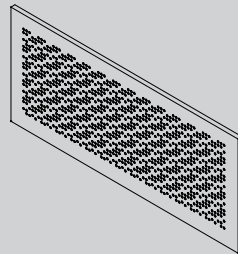

Tambour Doors

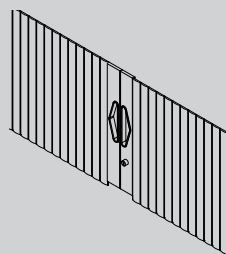

Sliding doors in Perspex or steel

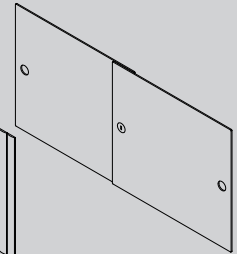

Planter

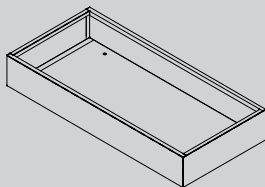

Desk Bracket

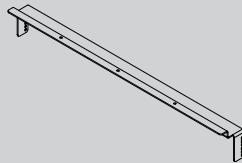

Dome Top

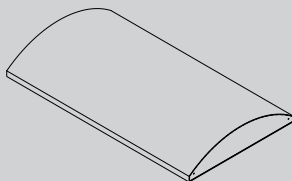

Sloping Top

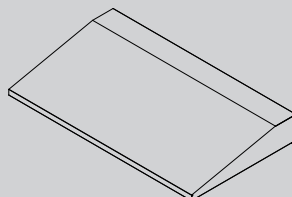

Curved Top

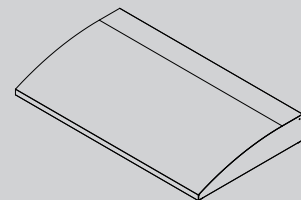





London Showroom -
45 Great Sutton Street
London
EC1V 0DE

Head Office
40 Barton Road
Water Eaton Industrial Estate
Milton Keynes, MK2 3EF
t. 01908 271688

sales@maine.co.uk

www.maine.co.uk